

# THE SHOPPES AT WINDMILL PLACE

BATAVIA, IL



## SIZE

124,576 square feet

## DEMOGRAPHICS

	1 mile	3 mile	5 mile
<b>Population</b>	5,593	52,795	118,859
<b>Households</b>	2,075	18,270	41,982
<b>Median HH Income (\$)</b>	94,567	114,448	102,077

## MAJOR TENANT(S)

Jewel-Osco  
Xfinity  
Dunkin'  
MyEyeDr  
GNC

## LEASING CONTACT

Andrew Schrage  
Mobile (317) 508-8119  
aschrage@phillipsedison.com

## MORE INFO

[www.phillipsedison.com](http://www.phillipsedison.com)

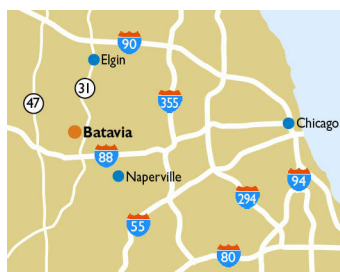
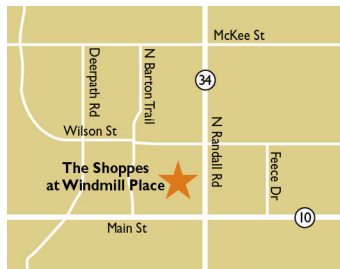

## LOCATION

119 South Randall Road | Batavia, IL 60510

## PROPERTY HIGHLIGHTS

- Anchored by Jewel Osco, the number one grocer in the Chicago area
- Located in Batavia, a western suburb of Chicago with a population exceeding 52,300 in a three-mile radius and an average household income greater than \$153,200
- The center is located at the high-traffic intersection of Randall Road and Main Street, which benefits from over 43,700 vehicles per day
- Other regional and national tenants include Dunkin', T-Mobile, GNC, Xfinity, Subway, MyEyeDr, Hair Cuttery, and Dave's Hot Chicken (coming soon)
- Over the past 12 months, The Shoppes at Windmill Place received over 1.3 million visits



**PHILLIPS EDISON & COMPANY®**

# THE SHOPPES AT WINDMILL PLACE

119 South Randall Road | Batavia, IL 60510

SPACE	TENANT	SQ. FT.			
A13	Jewel-Osco	64,930 SF	E1-B	Little Caesars	1,369 SF
A15	AVAILABLE	4,082 SF	E1-C	Connect Hearing	1,369 SF
A7	GNC	1,410 SF	E2	Fannie May Candies	1,200 SF
A9	Crosskicks Fitness	2,625 SF	E3	MyEyeDr	1,885 SF
B1	Dance School	5,000 SF	E4	Hair Cuttery	1,088 SF
B3	Maya's Furniture	7,060 SF	E5	CD One Price Cleaners	943 SF
C1	Xfinity	5,550 SF	E6	Gravitea	1,085 SF
C5	KidStrong	4,275 SF	E7	Dunkin'	2,400 SF
D1	T-Mobile	1,400 SF	E8	Zano Salon & Spa	4,342 SF
D11	East China Inn	2,100 SF	F1	Dave's Hot Chicken	2,400 SF
D13	Oui Travel	1,395 SF	SHADI BMO Harris Bank		
D3	Windmill Dental	1,368 SF	<b>TOTAL SQ. FT. 124,576</b>		
D5	Elite Tutoring	1,115 SF			
D7	Subway	1,400 SF			
D9	Paris Nails & Spa	1,365 SF			
E1-A	All Da Smoke & Vape	1,420 SF			

**SITE LEGEND**

- Available
- Leased (not occupied)
- Owned by Others
- Site Boundary
- Occupied

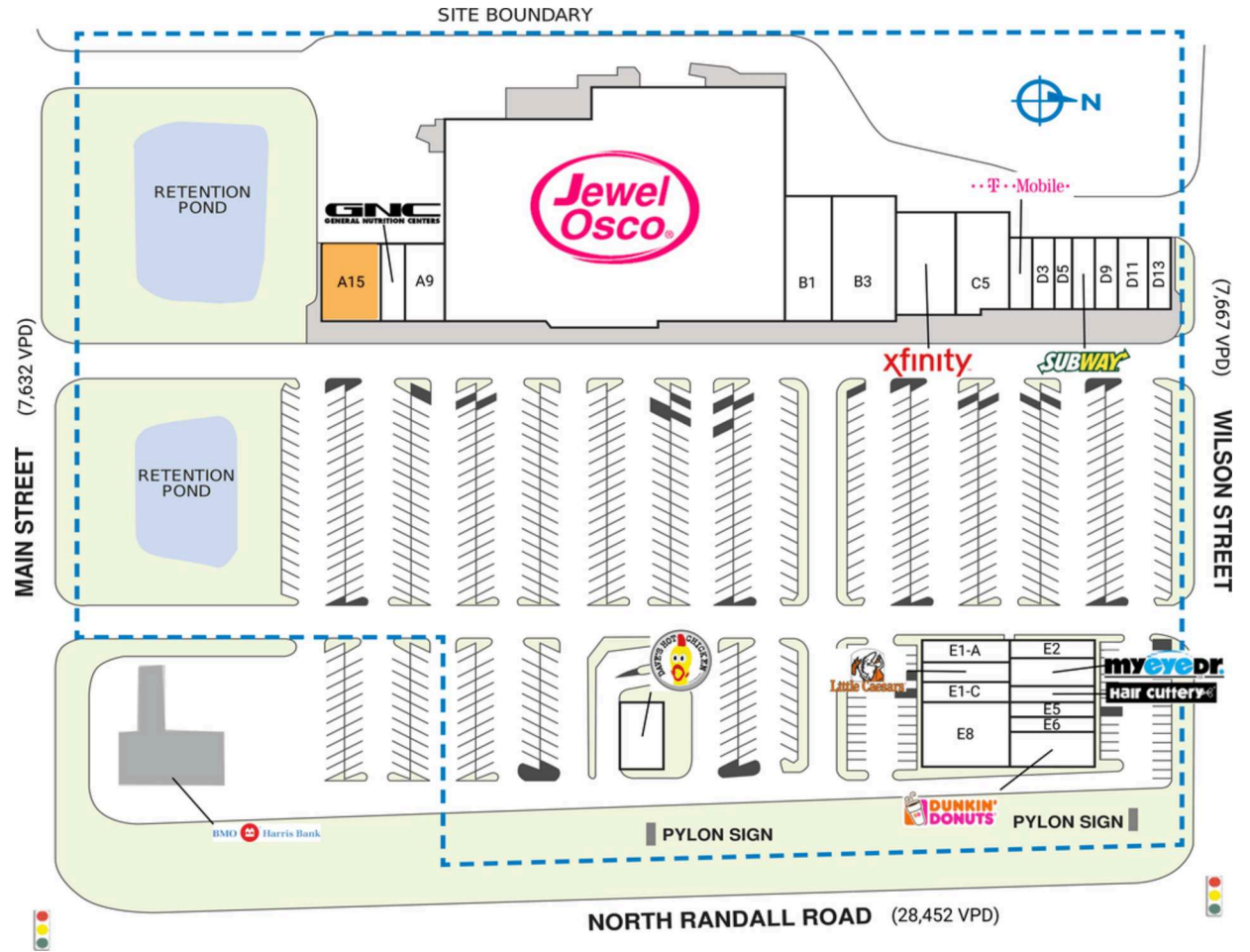

DISCLAIMER - This site plan is for general information purposes only and is not intended to constitute representations and warranties by Landlord as to the ownership of the real property depicted herein or the identity or nature of any occupants thereof.



# THE SHOPPES AT WINDMILL PLACE

119 South Randall Road | Batavia, IL 60510





# THE SHOPPES AT WINDMILL PLACE

119 South Randall Road | Batavia, IL 60510





# Demographic Summary Report

1990 - 2000 Census, 2022 Estimates & 2027 Projections

Calculated using TAS Retrieval Retrieval

Mar 20, 2023



The Shoppes at Windmill Place Batavia, IL		1.00 Mile Radius	3.00 Mile Radius	5.00 Mile Radius
Population	Q2 2022 Estimated Population	5,593	52,795	118,859
	2027 Projected Population	5,747	54,838	122,899
	2010 Census Population	5,575	50,999	116,598
	2000 Census Population	4,468	40,500	93,633
	1990 Census Population	2,564	26,441	69,988
	Historical Annual Growth 1990 to 2000	5.71%	4.36%	2.95%
	Historical Annual Growth 2000 to 2010	2.24%	2.33%	2.22%
	Estimated Annual Growth 2010 to 2022	0.02%	0.27%	0.15%
	Projected Annual Growth 2022 to 2027	0.55%	0.76%	0.67%
	Median Age	41.5	40.6	39.4
Households	Q2 2022 Estimated Households	2,075	18,270	41,982
	2027 Projected Households	2,131	18,977	43,448
	2010 Census Households	2,084	17,717	41,221
	2000 Census Households	1,705	13,986	33,122
	1990 Census Households	908	9,350	24,762
	Historical Annual Growth 1990 to 2000	6.50%	4.11%	2.95%
	Historical Annual Growth 2000 to 2010	2.03%	2.39%	2.21%
	Estimated Annual Growth 2010 to 2022	-0.03%	0.24%	0.14%
	Projected Annual Growth 2022 to 2027	0.54%	0.76%	0.69%
	Population per Household	2.69	2.85	2.76
Population by Race	White	85.4%	85.2%	76.7%
	Black or African American	3.5%	2.4%	4.3%
	Asian & Pacific Islander	2.0%	2.4%	2.9%
	Other Races	1.9%	2.2%	2.2%
	Hispanic Population	7.2%	7.9%	14.0%
Income	Average Household Income	\$126,282	\$138,772	\$127,697
	Median Household Income	\$94,567	\$114,448	\$102,077
	Per Capita Income	\$46,865	\$48,616	\$45,970
Education (Age 25+)	Elementary	0.5%	0.9%	2.6%
	Some High School	2.6%	2.4%	3.3%
	High School Graduate	12.5%	15.1%	17.9%
	Some College	20.0%	18.6%	19.6%
	Associates Degree Only	11.0%	7.1%	7.3%
	Bachelors Degree Only	31.8%	33.2%	29.8%
	Graduate Degree	21.7%	22.9%	19.5%
Business	Number of Businesses	155	1,547	4,274
	Total Number of Employees	2,781	25,170	64,547
	Employees per Business	17.98	16.27	15.10
	Residential Population per Business	36.16	34.13	27.81

This report was produced using data from private and government sources deemed to be reliable and is herein provided without representation or warranty.