

# LAFAYETTE SQUARE

2224-2500 Teal Road | Lafayette, IN 47905

SPACE	TENANT	SQ. FT.	01200 AVAILABLE	1,089 SF
ATM	Purdue Federal Credit Union ATM		01300 AVAILABLE	1,300 SF
OUT1	Burger King	3,200 SF	01400 Monica Spa	1,300 SF
OUT2	Wicked Food Shack	540 SF	01500 Discount Tobacco	1,300 SF
OUT3	Shell Gas Station	2,212 SF	01600 Chiffon's Beauty Supply	3,510 SF
00100	Rural King Supply	103,161 SF	01900 Dollar Tree Family Dollar	23,055 SF
00200	Big Lots	32,600 SF	02000 Humble Home	25,470 SF
00300	AVAILABLE	8,361 SF	02400 TNT Cleaners	2,507 SF
00400	Vicky's Beauty Salon	1,032 SF	02500 AVAILABLE	1,200 SF
00500	The Athlete	6,774 SF	02600 Road Star Driving School	2,160 SF
00610	Sherwin Williams	6,000 SF	03400 Harvest Chapel	13,042 SF
00700	Xinia Furniture	5,500 SF	03500 Little Shop of Wicked Gifts	1,149 SF
00800	En Lai Chinese Kitchen	1,644 SF	<b>TOTAL SQ. FT.</b>	<b>250,506</b>
01000	Subway	2,400 SF		

SITE LEGEND	
<span style="background-color: #FFC000; border: 1px solid black; display: inline-block; width: 15px; height: 10px;"></span> Available	<span style="border: 1px solid black; display: inline-block; width: 15px; height: 10px;"></span> Occupied
<span style="background-color: #ADD8E6; border: 1px solid black; display: inline-block; width: 15px; height: 10px;"></span> Leased (not occupied)	<span style="background-color: #A9A9A9; border: 1px solid black; display: inline-block; width: 15px; height: 10px;"></span> Owned by Others
<span style="border: 2px dashed blue; display: inline-block; width: 15px; height: 10px;"></span> Site Boundary	

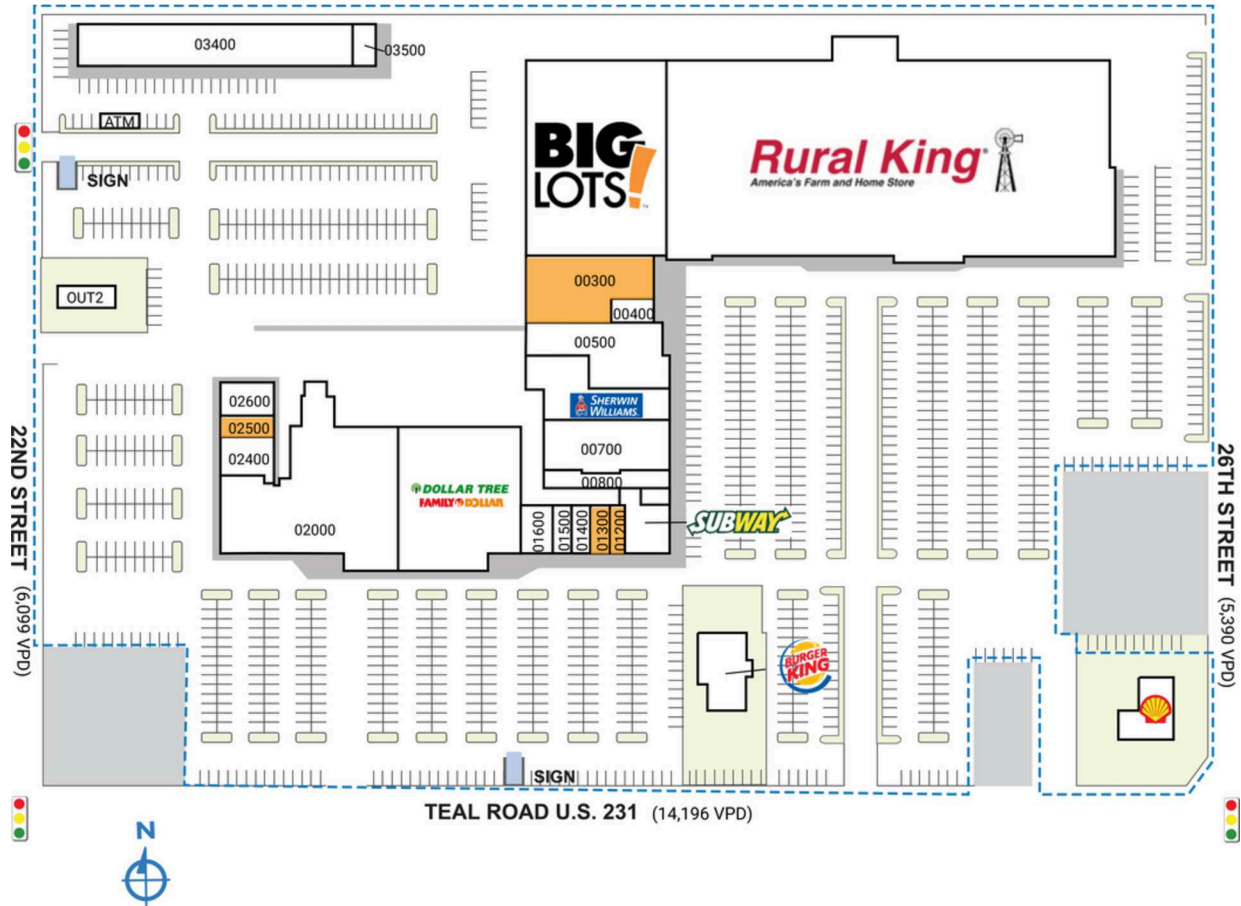

DISCLAIMER - This site plan is for general information purposes only and is not intended to constitute representations and warranties by Landlord as to the ownership of the real property depicted herein or the identity or nature of any occupants thereof.