

BROADWAY PAVILION

2440 South Broadway | Santa Maria, CA 93454

SPACE	TENANT	SQ. FT.		SQ. FT.
2410	Dollar Tree	13,408 SF	2528A One Hour Valley Cleaners	1,500 SF
2410B	Idler's Home	17,873 SF	2528B Paradise Juice Bar	1,125 SF
2414	Santa Maria Thrift	6,000 SF	2528C Nolan Dental	3,033 SF
2426	Paragon of Santa Maria	4,000 SF	2530A COMING AVAILABLE	1,725 SF
2430A	Starbucks	2,000 SF	2530B Revive Salon	2,025 SF
2430B	Nutrishop	1,280 SF	2530C Revive Salon 2	2,250 SF
2440	Food Maxx	49,950 SF	2530E AVAILABLE	1,125 SF
2502	Rent-A-Center	3,428 SF	2530F AVAILABLE	1,800 SF
2506	SESLOC Federal Credit Union	5,600 SF	2530G Taqueria La Unica	1,725 SF
2508	SB Restaurant	4,126 SF	2530H Baan Thai	1,125 SF
2512	New Image Thrift Store	9,446 SF	2530I Sassy Nails Lounge & Spa	1,357 SF
2524	La Luna Massage	1,870 SF	2530J Subway	1,275 SF
2526	Discount Cigarettes	1,530 SF	2530K One Life Fitness	2,100 SF
			TOTAL SQ. FT.	142,676

SITE LEGEND

- Available
- Leased (not occupied)
- Occupied
- Owned by Others
- Site Boundary

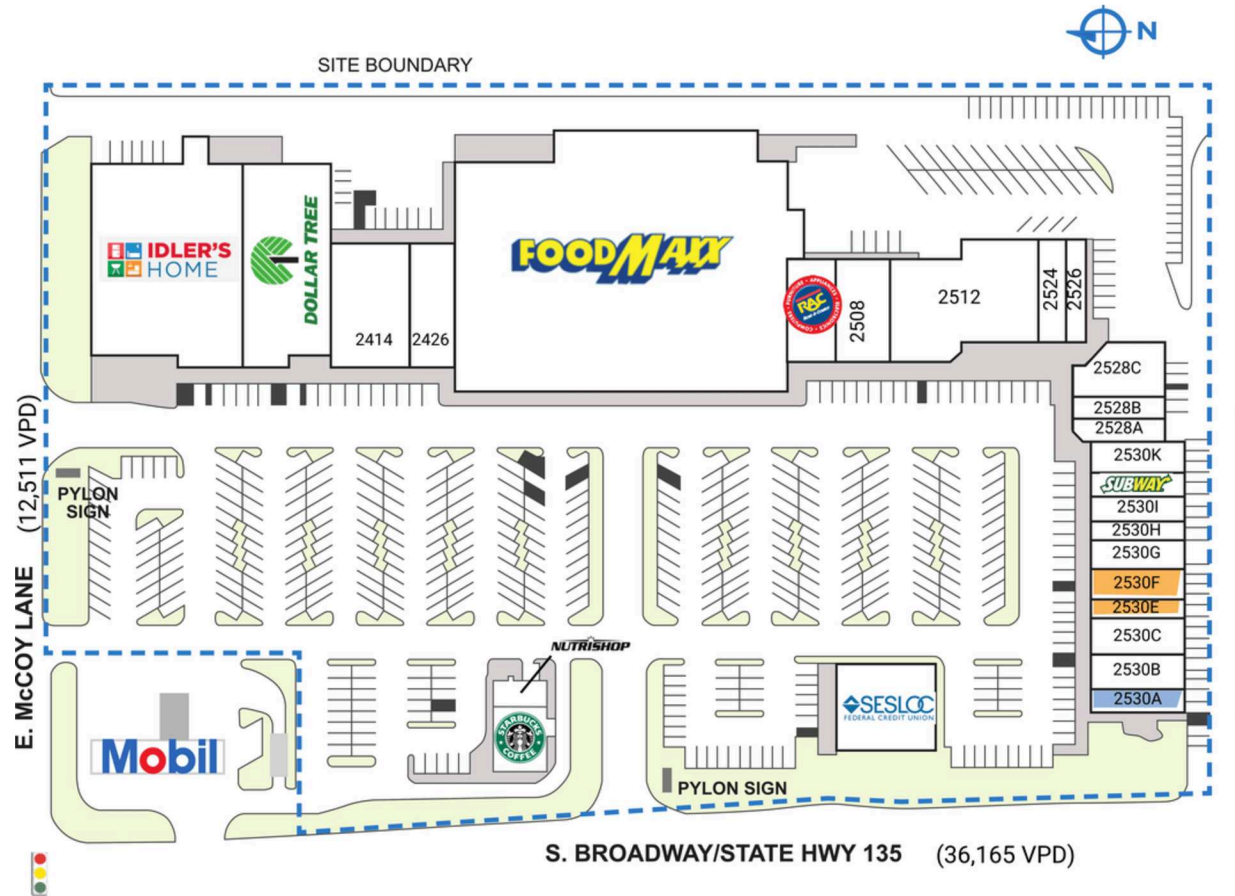

DISCLAIMER - This site plan is for general information purposes only and is not intended to constitute representations and warranties by Landlord as to the ownership of the real property depicted herein or the identity or nature of any occupants thereof.