

PORT ST. JOHN PLAZA

6257 US Highway 1 | Port St. John, FL 32927

SPACE	TENANT	SQ. FT.
6201	Chalkie's	3,500 SF
6211	Metro PCS	750 SF
6213	H&R Block	1,000 SF
6215	Cricket Wireless	750 SF
6217	Subway	1,250 SF
6221	Planet Fitness	8,640 SF
6225	Brigdawgs	1,200 SF
6227	Papa John's Pizza	1,200 SF
6231	Winn-Dixie Liquor	3,000 SF
6235	Nails Salon	900 SF
6237	Holly Kay's Salon	900 SF
6239	Endless Beauty	900 SF
6255	Player's Club	5,880 SF
6261	Winn Dixie	43,750 SF
6269	Pinch A Penny	2,220 SF
TOTAL SQ. FT.		75,840

SITE LEGEND

 Available	 Occupied
 Leased (not occupied)	 Owned by Others
 Site Boundary	

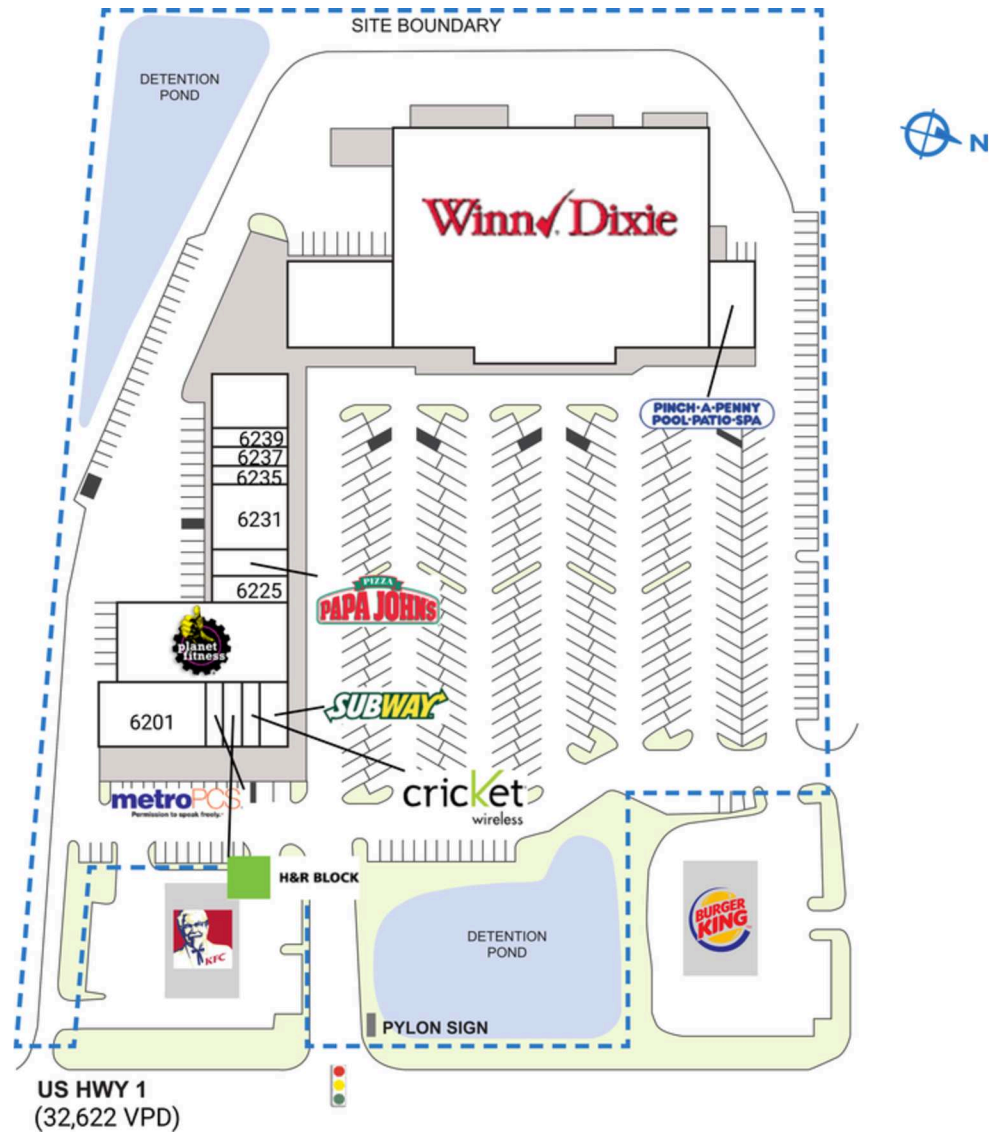

DISCLAIMER - This site plan is for general information purposes only and is not intended to constitute representations and warranties by Landlord as to the ownership of the real property depicted herein or the identity or nature of any occupants thereof.